



We innovate

Precision engineered suspension parts and poly bushings



www.superpro.com.au



Why SuperPro?

SuperPro is an Australian manufacturer of automotive polyurethane bushings and suspension parts based in Brisbane Queensland.

- ✓ Biggest range of polyurethane bushings and suspension parts
- ✓ Quality Solutions, global service with replacement and performance applications
- ✓ Designed, engineered and manufactured in Australia
- ✓ 3 year / 60,000km warranty

We have been creating unique polyurethane design solutions in our own factory for over 30 years and in 1983 started to manufacture bushes made from cast polyurethane.

Since then our product innovation and development record is a virtual timeline of milestones stretching back to the 70's that delivers real world results in better products, and, a reputation of leadership in automotive polyurethane manufacture worldwide with many industry firsts.

Our customers rely on the fact that we have the biggest **Range** of suspension bushes and sway bar bushing kits to suit their business needs.

For them, it really comes down to the **Technology** and **Innovation** that our design and manufacture processes are based on, coupled with the **Customer Support** and **Quality** they have come to rely on.



A unique suspension parts range that delivers outstanding performance benefits.

Toyota Hilux • Holden Commodore • VAG & VW Golf • Mitsubishi



Our Range

The Biggest Range of suspension bushes and sway bar bushing kits.

Backed by 30+ years of automotive industry experience in the toughest environments in the world, and supported by a full time, dedicated Research & Development Team with experience in Australia, Africa, Europe and America means our products are suited for all markets and global applications yet designed and developed in Australia for the highest quality and reliability of supply.

- ✓ Alignment Products
- ✓ Complete Bushing Kits
- ✓ Performance Suspension
- ✓ Suspension Bushes
- ✓ Roll Control Products
- ✓ Sway Bar Bushing
- ✓ Universal Products

We have global vehicle application coverage including poly bushing and suspension parts for:

EVO • Ford Mustang • Subaru WRX • Ford Falcon • Nissan Patrol



Australia's diversely unique conditions provide the perfect testing ground for SuperPro products.



Innovation Timeline >

BULLET GROOVES

Allowing for variances in control arms or spring eyes.



DOUBLE-HELIX GROOVES

Are used inside the bush and outside surface of the crush tube. Especially suitable for greaseable shackles.



Technology

- “Supaloy” Lighter, Leaner, high-stress alloy hardware with built in corrosion resistance
- “DuroBall” metal poly hybrid technology for vertical pivot bushings a win-win outcome
- “Dynamic Roll Control” solutions with the SuperPro advantage
- “Value Add” technology for smarter alignment corrections solutions

Our Research and Development process for SuperPro products constantly gathers information and feedback to provide continuous product improvements.

We constantly re-engineer and test our products on our own fleet of passenger vehicles and Four Wheel Drives.

Cyclic testing is performed using specifically designed testing equipment, to offer valuable information on the life and durability of SuperPro products.

Australia's diversely unique conditions provide the perfect testing ground for SuperPro products. Encompassing everything from extreme heat, dust, and harsh roads to race circuits, rally tracks, speedways and drag strips, SuperPro products are extensively tested in a variety of conditions to ensure the highest quality performance and reliability. Our products are also further tested in the diverse climates of Africa, Asia, Australasia, Europe, Middle East, South Pacific, UK and USA.

Our research and development process includes rigorous testing in the field and the lab.



SELF-LUBRICATION

Extends bush durability, excludes contaminants and assists polyurethane flow into grooves.



KNURLING

Reduced surface area ensures unrestricted pivoting of control arms

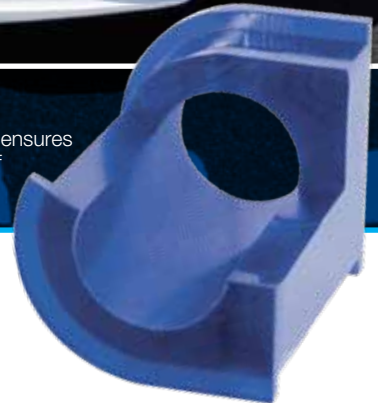

Innovation

- Flexible manufacturing and state of the art processes lead to superior quality
- Experience with leading manufacturers underpins and reinforces quality
- Tested in Antarctica our products possess outstanding resistance to thermal shock

At SuperPro we innovate with the latest technology in polyurethane and suspension design to give our customers the best possible suspension and chassis solutions.

Our research and development process includes rigorous testing in the field and the lab. A close connection to suspension and chassis specialist customers around the world guarantees real world solutions and answers to common problems. A timeline of innovative developments in design, engineering and manufacture delivers class leading value and high rates of customer satisfaction.



Real people providing real solutions to drive innovation and mutual success.



TANGENTIAL GREASE GROOVES

Grooves store grease therefore reducing friction between shackle bush heads and shackle plates and so reduces noise



SUPALOY

Lighter, Leaner, high-stress alloy hardware with built in corrosion resistance



Customer Support

- ✓ CD Desktop Catalogue
- ✓ PDF Catalogue
- ✓ Find your Bush Size facility
- ✓ How to Guides
- ✓ Size Listings and Measurements
- ✓ Tech Updates
- ✓ Two way communication channels so that you can communicate back to us

At SuperPro we employ over 100 staff with an extensive range of skills and expert knowledge.

This enables us to provide the advice and support our customers need when they need it.

Coupled with this extensive expertise, the SuperPro website provides a resource rich online support tool for customers, dealers and distributors.





Years of experience
and testing give
SuperPro a unique
grade of engineered
polyurethane.

DUROBALL

Metal poly hybrid
technology for vertical pivot
bushings a win-win outcome

DYNAMIC ROLL CONTROL

solutions with the
SuperPro advantage

Quality

- Our aim is for zero warranty claims
- Our parts are supplied under the requirements of the Production Parts Approval Process (PPAP)
- Rigorous testing in extreme conditions during design process
- Pioneers of innovative tooling designs to produce consistently high quality products

At SuperPro we aim to achieve zero warranty claims. We're backed by our customers and their experience. Strong partnerships are a key part in quality development.

Tenneco Automotive A range of SuperPro polyurethane bushings to suit both their original and aftermarket ride control products in Australia and South Africa.

Powerdown, an original equipment and aftermarket supplier to the Australian road transport industry use SuperPro polyurethane to meet the extreme conditions imposed by roads, loads and distances.

Mack Trucks use various components made with SuperPro polyurethane which are fitted to these vehicles as original equipment.

General Motors Holden use SuperPro alignment correction kits as part of their Parts and Accessories program.

EVO • Ford Mustang • Subaru WRX • Ford Falcon • Nissan Patrol



We innovate



www.superpro.com.au

28-40 Evesham Street, Moorooka, QLD 4105, AUSTRALIA

Call +61 7 3892 9000 | Fax +61 7 3892 1527 | Email mail@superpro.com.au